

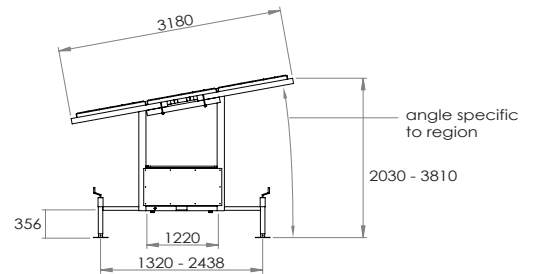

STAR 5i Description

These systems are configured to provide off power grid homes with power and light wired directly to the house.

- 12 x 300W solar panels (3600W total)
- 4 kW, 230V, 50Hz single phase inverter
- nominal usage is capable of providing up to 15.5 kWh per day
- fully charged, sixteen gel batteries provide 10.92 kWh of storage capacity
- minimal maintenance, safe and off the grid
- charging controller, station batteries and breakers/switches
- heavy duty steel frame is hot-dip galvanized
- onboard three stage temperature compensated charging and load management

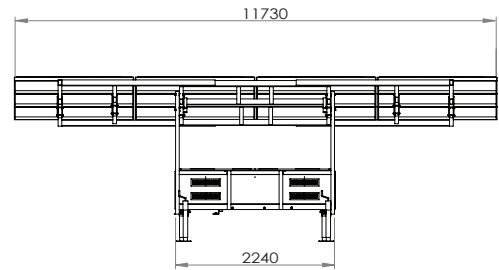
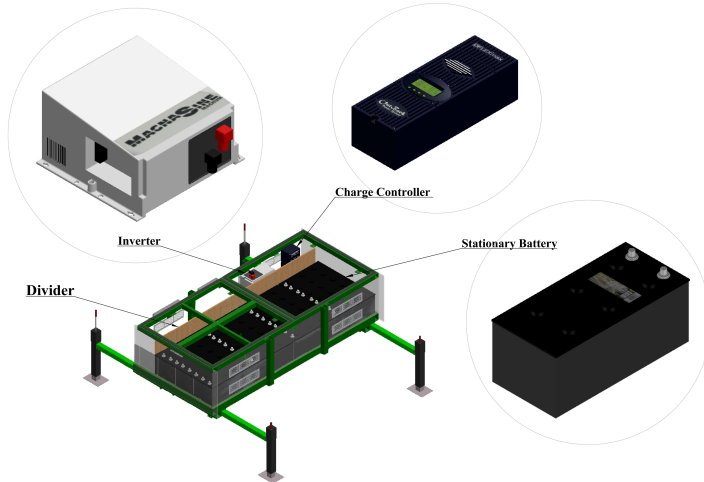
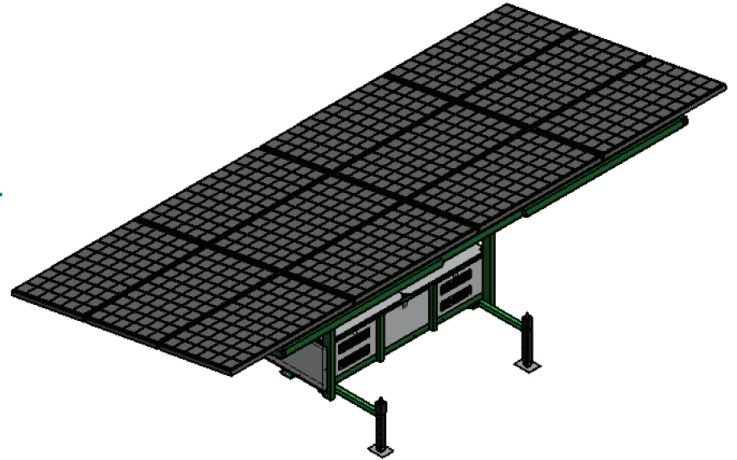

(Dimensions are in mm)

Inverter Features

This inverter powers your sensitive electronics without worry. The pure sine wave inverter and power factor corrected charger provide clean, reliable inverter power with low total harmonic distortion (THD) of less than 5%

STAR 5i can be backed up with generator power. It uses less energy from a generator than a standard charger - using 25-30% less AC current than standard chargers.

STAR 5i Specifications

Model	STAR 5i-12-16-4k
Solar Panels	12 x 300 watt
System Capacity (watts)	Up to 4000
Station Batteries	16 (200 amp Deep Cycle Gel)
Storage Capacity (kWh) *	10.92
Weight (kg)	2303
Full Deep Cycles	1500
Options	Trailer wheel kit

* 35% depth of discharge

contact

Michael Rubino
 VP, Systems Development at Dynamic Supplier Alignment
www.dynamicsupplieralignment.com
 (p) 516-322-7100 (e) Solar@dynamicupplieralignment.com



Station Battery Specifications



Valve-Regulated	Construction eliminates periodic watering, corrosive acid fumes, and spills
Plate alloy	Lead calcium
Container/cover	Polypropylene
Electrolyte	Sulfuric acid thixotropic gel
Valve	Self sealing

AMPERE HOUR CAPACITY 77°F (25°C)				PEAK RATING** [1.75 vpc @ 77°F (25°C)]		
10HR	20HR	24HR	100HR	5HR	20HR	100HR
169	183	187	210	153	193	213

**Peak Rating - Maximum amount of amp-hours a battery can deliver at a specified rate

gelled-electrolyte batteries is designed to offer reliable, maintenance-free power for renewable energy applications where frequent deep cycles are required and minimum maintenance is desirable.

Inverter Specifications

Inverter Specifications	
Nominal AC output voltage	230 VAC ± 5%
Output frequency and accuracy	50 Hz ± 0.4 Hz
Total Harmonic Distortion (THD)	< 5%
1 msec surge current (amps AC)	75
100 msec surge current (amps AC)	37
5 sec surge power (real watts)	7500
30 sec surge power (real watts)	7100
5 min surge power (real watts)	6600
30 min surge power (real watts)	5000
Continuous power output at 25° C	4300 VA
Inverter efficiency (peak)	91%
Transfer time	~20 ms
No load (230 VAC output, typical)	28 watts
Waveform	Pure Sine Wave

Environmental Specifications	
Operating temperature	-20°C to + 60°C (-4°F to 140°F)
Nonoperating temperature	-40°C to + 70°C (-40°F to 158°F)
Operating humidity	0 to 95% RH non condensing
Max operating altitude	4570 m (15,000')